

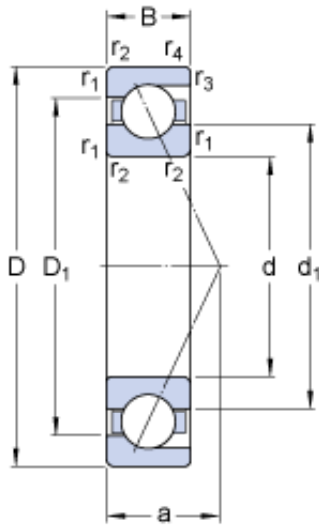

# NSK BEARING CORP.OF AMERICA



71964 AC Bearing 2D drawings and 3D CAD models

## SKF 71964 AC angular contact ball bearings

Bearing No. 71964 AC

Size	440x320x56 mm
Bore Diameter	440 mm
Outer Diameter	320 mm
Width	56 mm
d	320 mm
D	440 mm
B	56 mm
d <sub>1</sub>	359 mm
D <sub>1</sub>	404 mm
a	116 mm
r <sub>1,2</sub> - min.	3 mm
r <sub>3,4</sub> - min.	1.1 mm
d <sub>a</sub> - min.	333 mm
D <sub>a</sub> - max.	427 mm
D <sub>b</sub> - max.	432 mm
r <sub>a</sub> - max.	2.5 mm
r <sub>b</sub> - max.	1 mm
Basic dynamic load rating - C	351 kN
Basic static load rating - C <sub>0</sub>	585 kN
Fatigue load limit - P <sub>u</sub>	12.9 kN
Reference speed	1500 r/min
Limiting speed	1600 r/min
Calculation factor - k <sub>r</sub>	0.083
Calculation factor - k <sub>a</sub>	0.25
Calculation factor - e	0.68



## NSK BEARING CORP.OF AMERICA

Calculation factor - X	0.41
Calculation factor - Y <sub>0</sub>	0.38
Calculation factor - Y <sub>1</sub>	
Calculation factor - Y <sub>2</sub>	0.87
d <sub>1</sub>	359 mm
D <sub>1</sub>	404 mm
r <sub>1,2</sub> min.	3 mm
r <sub>3,4</sub> min.	1.1 mm
d <sub>a</sub> min.	333 mm
D <sub>a</sub> max.	427 mm
D <sub>b</sub> max.	432 mm
r <sub>a</sub> max.	2.5 mm
r <sub>b</sub> max.	1 mm
Basic dynamic load rating C	351 kN
Basic static load rating C <sub>0</sub>	585 kN
Fatigue load limit P <sub>u</sub>	12.9 kN
Calculation factor A	1.71
Calculation factor k <sub>r</sub>	0.083
Calculation factor e	0.68
Calculation factor X	0.41
Calculation factor Y <sub>0</sub>	0.38
Calculation factor Y <sub>2</sub>	0.87
Mass bearing	25.5 kg